

FIG

Kathmandu, Nepal 14–16 November
REGIONAL CONFERENCE 2024



Climate Responsive Land Governance and Disaster Resilience: Safeguarding Land Rights



Organised by



Main National Supporter



Main Institutional Partner



Platinum Sponsor



CONTENTS

Greetings from the Organisers	2
Conference Organisers	5
General Conference Information	6
Conference Theme	8
Conference Venue	10
Programme at a Glance	11
Opening Ceremony	12
Plenary Sessions	14
FIG Corporate Members	19
Social Programme & Technical and Social Tours	20
Conference Partners, Supporters & Sponsors	23
Technical Programme	26
• Main Conference Overview (by rooms)	26
• Pre-Conference Events (13 November)	27
• Thursday 14 November	28
• Friday 15 November	30
The FIG Foundation	33
Exhibition	34



Dear Friends and Colleagues,

Welcome to the FIG 2024 Regional Conference in Kathmandu, where an inspirational program awaits you. Co-hosted by FIG and Nepal Institution of Chartered Surveyors (NICS) the aim is to promote the important role of surveying profession in translating sustainable development goals into action and enhancing community resilience to climate change.

Professionals have an instrumental part to play in navigating the global mega trends affecting societies. Climate action is underpinning everything we need to do now. To walk the path to climate equity we need adaptive and resilient action.

The FIG strategic work plan emphasises a more significant role for survey professionals in the climate agenda. Thanks to the excellent organisation of NICS, the conference will be a major milestone in achieving the FIG vision to think about the way we approach the climate and land challenges of today. The theme strategically aligns to the 2030 Agenda and our discussions will contribute to FIGs collective responsibility to address the SDGs.

The conference objective reflects FIG strategic purpose to tackle the global challenges and to leave no one behind. Land governance must accommodate the relationship between land resources and climate change this is complex and necessitates a strategic action. In particular safeguarding land rights amid increasing natural disasters requires a sustainable, resilient approach, which also helps reduce poverty, biodiversity loss and improve water resources management and increase food security.

FIG community actively builds professional knowledge and capacity, recognizing that effective partnerships ensure stronger engagement. This aligns with the second conference objective: fostering collaborative, multistakeholder dialogues among national governments and regional stakeholders to facilitate knowledge sharing and technology transfer. We greatly appreciate the support and engagement of our strategic partners, including the World Bank, GLTN/UN-Habitat, Nepal ministries, and our platinum sponsor, Trimble.

The conference will culminate in an agreed 'Call to Action' to engage all regional stakeholders.

The conference will culminate in an agreed 'Call to Action' to engage a range of regional actors including government institutions, academics, and professional stakeholders.

As the world and climate change, FIG aspires to leverage its knowledge base and tools for measuring, monitoring, and forecasting how to improve the outlook for our future generations. Our profession has a key role in bridging the gap between high level strategy and policy and actions on the ground for sustainable, resilient development and to tackle the climate agenda.

I am so pleased that the organisers have done their very best to arrange a memorable event. On behalf of FIG Council and office I extend to you a warm welcome to the FIG Regional conference in Nepal.

Diane A Dumashie / FIG President



***Dear Esteemed Guests, Valued Speakers,
and Participants,
Namaskar!***

On behalf of the Nepal Institution of Chartered Surveyors (NICS) and the Local Organizing Committee (LOC), it is a great privilege to welcome you all to the FIG Regional Conference 2024, here at the Hotel Yak and Yeti in Kathmandu, Nepal. Hosting an event of this scale under the prestigious umbrella of the International Federation of Surveyors (FIG) in Nepal has been one of our dreams, and today, this dream has come true.

With the theme “Climate-Responsive Land Governance and Disaster Resilience: Safeguarding Land Rights,” our aim for this conference is to build a robust foundation of knowledge and capacity to tackle the pressing challenges posed by climate change and natural disasters in protecting land rights. We aspire to promote climate-responsive land governance for resilient societies. We believe that your presence here reflects a shared commitment to advancing land governance and strengthening disaster resilience in the face of climate-related challenges.

We also hope to foster meaningful partnerships among national and regional institutions, academics, and professionals from various sectors—including governments, development partners, non-governmental organizations, non-state actors, and the private sector. Our objective is to inspire multistakeholder

dialogues, facilitate knowledge exchange, and support technology transfer across the region.

We believe in the principle of “Atithi Devo Bhava” or “The Guest is God,” and have endeavored to extend our best hospitality. We trust that our distinguished international speakers, invitees, and participants will feel welcome and comfortable. We also hope that the rich cultural heritage and natural beauty of the Kathmandu Valley—a city nestled amid the Himalayas, vibrant with history and tradition—will meet your expectations. May your stay here be both enjoyable and productive, providing you with a memorable experience in Nepal.

Similarly, we trust that our distinguished guests, invitees, and participants from Nepal will benefit from the opportunity to gain valuable insights on this theme and expand their professional networks.

We are deeply grateful to FIG for honoring our request to host this event in Nepal. We also extend our heartfelt thanks to our co-organizers, partners, sponsors, esteemed speakers, and distinguished participants, whose generous support and contributions have made this event possible.

Thank you once again for joining us in this significant initiative. We look forward to the inspiring discussions, innovative ideas, and lasting partnerships that will emerge from this gathering.

Sincerely

Ganesh Prasad Bhatta

Chair, LOC – Co-Conference Director – FIG Representative–NICS







International Federation of Surveyors (FIG)

FIG is a United Nations and World Bank recognised non-governmental organisation. Founded in 1878, FIG represents the interest of surveyors worldwide. Our members



Nepal Institution of Chartered Surveyors (NICS)

NICS, the only association of licensed surveyors in Nepal, was established in 2008 aiming to contribute in professional development in the country along with professional security of its members. The association is dedicated and determined to comply the code of conduct, norms, standard and specifications set by the concerned government department and organization. Furthermore,

measure, position, map, locate, appraise and value, estimate and cost, plan, construct, develop and manage the land, the seas and any man-made structures with a vision to extend the usefulness of surveying for the benefit of society, the environment, and the economy.

NICS is the only member association of FIG from Nepal. This association is an association of licensed surveyors of Nepal licensed under the provision of Article 11(E) of Land (Surveying and Mapping) Act, 1963. The main objective of this institution is development, cooperation, advising the survey and mapping activities and related science in Nepal as a professional NGO. NICS seeks to create a unique opportunity in Nepal and beyond to focus on resolving regional land-related issues for the betterment of vulnerable communities.

Conference Steering Committee

- Dr. **Diane Dumashie**, FIG President
- Mr. **Tirtha Bahadur Pradhanang**, President, NICS
- Mr. **Buddhi Narayan Shrestha**, Past President, NICS
- Mr. **Punya Prasad Oli**, Immediate Past President, NICS
- Mr. **Janak Raj Joshi**, Exec. Director, Land Management Training Center
- Mr. **Prakash Joshi**, Survey Department, Director General
- Ms. **Louise Friis-Hansen**, FIG Director and Co-Conference Director

Local Organising Committee

- Mr. **Ganesh Prasad Bhatta**, Co-Conference director, NICS
- Mr. **Niraj Manandhar**, Vice President, NICS
- Dr. **Reshma Shrestha**, Associate Professor, Kathmandu University
- Mr. **Shambhu Gyawali**, General Secretary, NICS
- Mr. **Nirmal Acharya**, Treasurer, NICS
- Mr. **Nagendra Jha**, Member, NICS
- Mr. **Sharad Chandra Dawadi**, Secretary, NICS
- Mr. **Jagat Raj Paudel**, Member, NICS
- Mr. **Ujjwal Chandra Gautam**, Member, NICS
- Ms. **Tina Baidar**, LOC Secretariat Member
- Mr. **Sanjeevan Shrestha**, LOC Secretariat Member

Technical Committee

- Mr. **Ganesh Prasad Bhatta**, Nepal, Chair
- Ms. **Clarissa Augustinus**, FIG Task Force Climate Compass
- Ms. **Paula Dijkstra**, FIG Task Force on FIG and the SDGs
- Dr. **Mika-Petteri Torhonen**, World Bank
- Mr. **Danilo Antonio**, World Bank
- Mr. **John Gitau**, UN-Habitat GLTN
- Ms. **Hellen Ndung'u**, UN-Habitat, GLTN
- Dr. **Victor Olonde**, UN-Habitat, GLTN
- Dr. **Reshma Shrestha**, Associate Professor and Head of the Department of Geomatics Engineering at Kathmandu University
- Dr. **Dimo Todorovski**, FIG Commission 2
- Dr. **Ryan Keenan**, FIG Commission 5
- Mr. **Peter Ache**, FIG Commission 9

FIG Office

- Ms. **Louise Friis-Hansen**, FIG Director and Co-Conference Director
- Ms. **Maria Bargholz**, FIG Finances and Administration

General Conference Information

The FIG Regional Conference 2024, themed “Climate Responsive Land Governance and Disaster Resilience: Safeguarding Land Rights,” promises an engaging agenda centred around climate change, land rights, and disaster resilience. The conference will begin on November 13 with the 5th FIG Young Surveyors Network Asia and the Pacific Meeting in Dhulikhel, Nepal. This event, themed “Empowered Youth for Climate Resilient Lands,” invites young surveyors from across the region to address climate change challenges and build networks for sustainable land management.

The conference’s official opening on November 14 includes keynote addresses and parallel panel sessions with esteemed speakers discussing critical issues in on climate responsive land governance. The evening will feature a social dinner at Regal Ballroom of Hotel Yak & Yeti, where attendees can unwind, enjoy diverse cultural performances, and celebrate the first day’s accomplishments. On No-

Map of the City and Explanation

During the conference days, in off-hours, you can explore some of Kathmandu Valley’s most significant religious, cultural and historical sites. Consider visiting Pashupatinath Temple, a sacred Hindu site known for its deep spiritual significance. You may also visit Swayambhunath Stupa (the “Monkey Temple”), which is ideal for both sunrise and sunset, offering stunning views of the valley.



vember 15, the conference resumes with parallel plenary sessions on emerging trends and innovative practices in land administration in disaster resilience. The conference will conclude with a closing ceremony, celebrating shared insights and collaborative goals. A Call-for-action will be published and handed over to Ministry of Land Management, Cooperatives and Poverty Alleviation after the conference based on the outcome of each session.

For participants who have registered for the social/technical tour, the tour through Kathmandu Valley offers a chance to explore Nepal’s cultural and technical landmarks. Highlights include a sunrise in Nagarkot overlooking the Himalayas, a visit to the Nagarkot Geodetic Observatory, and exploration of the UNESCO World Heritage site in Bhaktapur. Participants will also tour the Land Management Training Center and Kathmandu University in Dhulikhel, followed by lunch in a tranquil setting. The tour concludes with a walk through Handigaun’s vibrant car-free streets, showcasing local food, crafts, and cultural activities.

For a peaceful Buddhist experience, Boudhanath Stupa, a Tibetan Buddhist pilgrimage site, is perfect for an evening visit, especially as the area lights up with butter lamps.

For an appreciation of Nepal’s architectural heritage, Basantapur Durbar Square and Patan Durbar Square offer remarkable examples of Shah dynasty architecture and traditional Newari culture. These squares feature intricate temples, courtyards, and palaces that speak to Kathmandu Valley’s rich history.

After a day of exploring, enjoy the vibrant nightlife at Thamel. This lively area is full of shops, cafes, and local life, making it a great spot to unwind, shop, and soak in the city’s modern energy. Feel free to bargain in local shop and stalls, where it’s often expected, but keep in mind that supermarket, café and fixed price shops have set rates.

Registration and Conference Services

The FIG Registration desk is located on the ground floor.

Opening hours: Thursday 14 November 7:30–9:00 and Friday 15 November 8:00–15:00.

Submission of Presentation Slides

You can upload your final presentation to the FIG Regional Conference 2024 Secretariate to fig.reg.conference2024@gmail.com. It is also possible to submit your presentation at the registration desk. Please submit no later than one hour before your session starts.

Badges

Each registered delegate will receive a badge, which serves as the official pass for entry to all sessions, the exhibition, and the Welcome Dinner. Do not lose or forget your badge. New badges will not be issued.

Conference Bag

Delegates who opt for it during registration will receive a conference bag.

Other Nice Things to Know

After the conference, you can enjoy a day tour by vehicle to explore some of Kathmandu Valley's remarkable attractions such as Bhaktapur Durbar Square, a UNESCO World Heritage Site and open-air museum celebrated for its stunning temples, statues, and courtyards. Nagarkot is famous for panoramic sunrise or sunset views over the Himalayas—an ideal spot to witness the breathtaking mountain landscape. Another great option is to experience the tranquillity of Namobuddha Monastery, a revered pilgrimage site nestled on a peaceful hillside in Kavre district, approximately 42 km from Kathmandu. This serene setting offers a beautiful escape with its spiritual ambiance and scenic views. If you're a hiking or trekking enthusiast, the valley offers several excellent hill trails like Shivapuri, Champadevi, Phulchoki and Chandragiri Hill Trails.

For a unique experience, consider a Mountain Flight to enjoy breathtaking close-up views of Everest, Annapurna, and other Himalayan ranges. If you're seeking adventure, try bungee jumping at the Last Resort in Sindhupalchowk (about 100 km from Kathmandu) or paragliding in Dhulikhel (30 km from Kathmandu) for a thrilling view of the valley and surrounding landscapes. Major tourist destinations outside Kathmandu valley are Pokhara, Chitwan, Lumbini, Illam, Janakpur and many more.

Refreshment and Lunches

On the two conference days, coffee and tea will be available for free during the morning and afternoon breaks at designated coffee stations in the exhibition areas. Lunch on Thursday and Friday will be provided in Durbar Hall.

Conference Web Site and Technical Programme

- Conference web site:
www.fig.net/nepal2024
- Technical programme:
fig.net/nepal2024/technical_program.htm

Wireless Internet

Wireless Internet is available at the conference venue.

Social Media

FIG at LinkedIn:

www.linkedin.com/company/fig---international-federation-of-surveyors

FIG at Facebook:

<https://www.facebook.com/internationalfederationofsurveyors>

FIG YouTube Channel:

<https://www.youtube.com/channel/UCn1LnXagUY5Y2f8Hy-yaw2Q>

FIG at Xr:

https://x.com/FIG_NEWS

FIG at Instagram:

<https://www.instagram.com/figsurveyors>
#FIGNepal2024



Climate Responsive Land Governance and Disaster Resilience: Safeguarding Land Rights



Kathmandu, Nepal
14–16 November

Regional Conference 2024



With a special focus on Climate and Disaster 12 dedicated technical sessions await you in this special Regional Conference. All sessions are designed around the main conference theme.

The UN's 2030 Agenda for Sustainable Development is an ambitious plan of action that inspires global society to think creatively and critically rethink the way we approach the development challenges of today. This theme underpins the FIG Council's vision of sustainability over the term 2023–2026. Additionally, FIG provides a platform to raise awareness, inform and inspire the FIG community on the 2030 Agenda and the SDGs.

Because of the importance of climate change to the global community and the 2030 Agenda, FIG wishes to examine and actively promote the engagement and role that surveyors, valuers and land practitioners can play in contributing to the climate change agenda and the achievement of the Sustainable Development Goals. FIG wishes to lead its members so that they can fully understand, articulate and use their expertise and knowledge to tackle the important challenges in climate action.

Surveyors, valuers and land practitioners are in the critical path of the sustainability of the planet because of their work on security of tenure, land governance, geospatial information management, land administration and land management, spatial planning and valuation, BIM and so on. Future generations in the Asia region face an uncertain outlook characterized by an increasingly hostile climate and poorly managed natural disasters. Surveyors and land practitioners in the Asia region, with their critically important skills and knowledge, need to contribute to addressing the climate crisis challenges.

The primary aim of this Regional Conference for Asia is to address the pressing challenges posed by climate challenges and disasters and their impacts in the region, with a focus on the vi-

tal role of effective land governance and resilience. There is an imperative need to share international and regional knowledge and best practices. The Regional Conference is an opportunity for learning, sharing knowledge, providing practical knowledge and actionable recommendations about how surveyors and land practitioners can address climate and disaster in the region, also for vulnerable communities. This will be done through a focus on 4 thematic areas 1) Climate responsive land governance 2) Natural disaster resilience for communities, professionals and organizations 3) Cooperation and partnerships to safeguard land rights 4) Capacity development for communities, professionals and organizations.

Call to Action Publication

The outcome from all sessions will contribute to a final 'Call to Action' publication which will be produced based on the conference findings and is aimed to be used to engage regional governments, professionals, and stakeholders. It will feature recommendations derived from the event.

The Call to Action aims to deliver concrete strategies and actionable recommendations to

- Strengthen and safeguard land rights against climate challenges.
- For collaborative partnerships for climate resilience and to bridge gaps.
- Enhance disaster resilience through knowledge and capacity.
- Enhance regional responses through best Practices and fit-for-purpose standards.
- Strengthen land governance and empower land practitioners.
- Increase monitoring and measuring for climate action.



Nakul Shrestha



Geovation Nepal - Shishir Lamsal



Geovation Nepal - Shishir Lamsal



Geovation Nepal - Shishir Lamsal



Geovation Nepal - Shishir Lamsal



Geovation Nepal - Shishir Lamsal



Photos: www.yakandyeti.com

FIG Regional Conference 2024 is held at Hotel Yak & Yeti, Kathmandu

Street Address: Durbar Marg, Kathmandu

<https://www.yakandyeti.com/>

Conference rooms: Regal (top left), Durbar Hall (top right), Viceroy/Senate (bottom left), Regency Hall (bottom right).

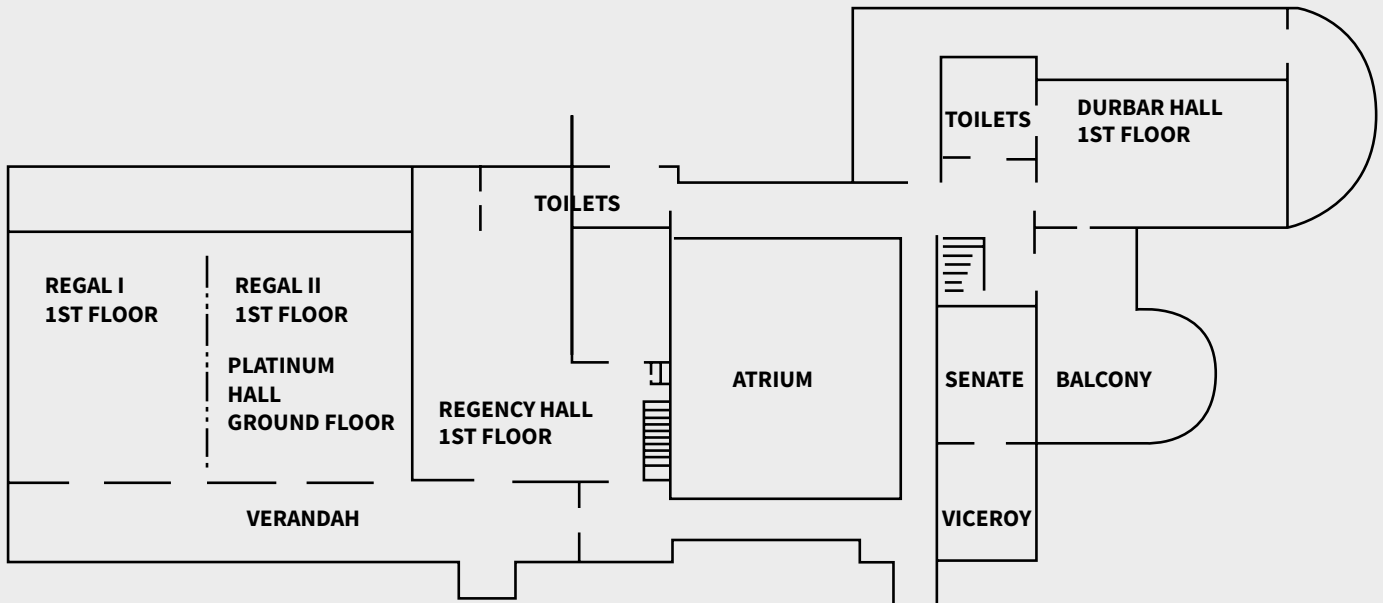

Ground Floor

Platinum Hall	B Sessions
Lobby/Veranda	Registration Desk
Crystal Hall	(Not used)

First Floor

Regency Hall	Exhibition Area, Tea Breaks
Durbar Hall	Lunch Area
Regal Ball Room	Main Event Hall
Regal I & Regal II	C and A Sessions
Senate Hall	Office Space

THURSDAY 14 NOVEMBER			
09:00–10:45	Opening Ceremony		
10:45–11:15	Tea Break		
11:15–12:45	Plenary Session I : Climate Responsible Land Governance		
12:45–13:45	Lunch		
13:45–15:15	TS01A: Innovative Approaches to Urbanization, Land Management, and Climate Resilience	TS01B: Unlocking Property Values through Greater Transparency of Sustainability Effects on the Markets	TS01C: Towards a Modern and Localized Land Administration System: Launch of the Technical Assistance on the Digitalization of Nepals Land Administration Sector
15:15–15:45	Tea Break		
15:45–17:15	TS02A: Climate and Disaster Resilient Rural Land Use Planning	TS02B: Enhancing Disaster & Climate Resilience through Knowledge and Capacity	TS02C: Property Valuation Systems and Standards: Addressing Challenges and Unlocking Opportunities
18:00–21:00	Welcome Dinner (Included in Registration Fee)		
FRIDAY 15 NOVEMBER			
08:00–08:45	TM01: Meeting on Call to Action		
09:00–10:45	Plenary Session II: Disaster Resilience		
10:45–11:15	Tea Break		
11:15–12:45	TS03A: Innovative Land Administration Approaches, Global Land and Environmental Frameworks	TS03B: Leveraging Remote Sensing, GIS, and Technological Innovations for Sustainable Development	TS03C: Towards Effective Property Valuation and Taxation: Lessons, Analytics, and New Horizons
12:45–13:45	Lunch		
13:45–15:15	TS04A: Safeguarding Land Rights amidst the Impacts of Climate Change and Disasters	TS04B: Partner Spotlights	TS04C: Round Table Discussion on Property Valuation and Taxation
15:15–15:45	Tea Break		
15:45–17:15	Closing Ceremony		
SATURDAY 16 NOVEMBER			
04:30–17:00	Technical/Social Tour		

Thursday 14 November at 9:00–10:45

Regal Ballroom, Hotel Yak and Yeti, Kathmandu

Chair: Mr. Tirtha Bahadur Pradhanang, Nepal, President of NICS

Welcome to Nepal. Join us in this festive inaugural ceremony with addresses and keynote presentations. Inaugural address by Hon' Balaram Adhikari Minister for Land Management, Cooperatives and Poverty Alleviation.

Programme

- **Welcome Remarks** – Mr. **Ganesh Prasad Bhatta**, Chair LOC
- **Keynote** – Dr. **Diane Dumashie** (United Kingdom): Land Governance for Climate Action: The Imperative for Land Professionals to Act
- **Keynote** – Mr. **Bryn Fosburgh** (USA): Next Phase Technological Solutions
- **Keynote** – Dr. **Mika-Petteri Torhonen** (Finland): Access to Land for Climate Goals in South Asia Region
- Remarks by UN Resident Director from Nepal
- Felicitations by Sponsors and Exhibitors, Past Presidents and Treasurer
- Inaugural Address by the chief guest: Hon' **Balaram Adhikari**, Ministry of Land Management, Cooperatives and Poverty Alleviation
- Closing by the Chair, NICS
- Group Photo and Opening of the Exhibition





Inaugural Address

Chief Guest: Hon' **Balaram Adhikari**,
Ministry of Land Management, Cooperatives and Poverty Alleviation



Special Guest: Mr. **Arjun Prasad Pokharel**, Secretary,
Ministry of Land Management, Cooperatives and Poverty Alleviation

The honourable Secretary will receive the Call to Action by FIG President **Diane Dumashie** in the Closing Ceremony.



Keynote: *Land Governance for Climate Action: The Imperative for Land Professionals to Act*

Dr. Diane Dumashie, president of the International Federation of Surveyors,

emphasizes in the FIG Council Work Plan 2023–2026 the imperative for a sustainable profession that provides services in a sustainable manner and aligns with the global sustainable development agenda. It highlights the urgency to take action now to address the climate agenda.

Working in the UK and international landscapes, with significant work on the African continent she has an extensive background in operationalizing policy in land and property and developing stakeholder engagement.

Diane is widely acknowledged as a creative and strategic business thinker with a proven ability to lead and manage change, to energise and resolve complex issues and deliver successful outcomes for all stakeholders.

Her independent practice supports public sector agencies to deliver complex land, property, and infrastructure regeneration projects with a focus on economic and social development.

Diane's thematic specialties include land management, land rights, land use, land development, major project delivery, and infrastructure, particularly in urban and coastal master planning and regeneration. Internationally, she assists public sector and multilateral agencies in improving the sustainability of people's livelihoods

Dedicated to giving back to her profession Diane was a key co-lead in developing and promoting secure land tenure titles for women and holds a number of Board positions.



Keynote: *Next Phase Technological Solutions*

Mr. **Bryn Fosburgh** is a Senior Vice President at Trimble and is currently the Advisor to the CEO. Since 1994, Bryn has been involved and led Trimble's Geospatial, Construction, Transportation and Logistics (T&L), and Agriculture Sectors. Bryn is the founding member of Trimble's joint ventures with Caterpillar, Hilti, AGCO, and Nikon and has spent over twenty years on those joint venture boards. Bryn is also the founder of Trimble's consolidated construction and T&L businesses and has had direct responsibility for managing the profit and loss centers at Trimble which were greater than billion dollars in revenue.

Prior to Trimble, Bryn worked nearly 10 years in the Federal and State Government at the Wisconsin Department of Transportation, U.S Army Corps of Engineers, and Defense Mapping Agency (DMA). Bryn received a Masters of Science in Civil Engineering at Purdue University and a Bachelor of Science from University of Wisconsin Green Bay.

Bryn is a supporter of the FIG Foundation, currently Foundation President, since its inception and passionately supports the FIG young surveyors network through mentorship and educational and philanthropic efforts.



Keynote: *Access to Land for Climate Goals in South Asia Region*

Mr. Mika-Petteri Torhonen is the Global Lead on Land of the World Bank based in Singapore. He is a Land Surveyor specialized in tenure security and land registration programs since early 1990's. He leads the World Bank's professional Community of Practice of land administration specialists and Mika has been instrumental in developing the World Bank's investment lending and knowledge operations portfolio in land and geospatial system modernization. His current interest areas include access to land for climate actions and infrastructure development, and developing property valuation standards, infrastructure and solutions. Mika is a Finnish National and holds a Doctor of Science Degree from the Helsinki University of Technology (Aalto University).

Plenary Session I : Climate Responsible Land Governance

Time: Thursday 14 November 2024 at 11:15–12:45

Place: Regal Ballroom, Hotel Yak and Yeti, Kathmandu

Chair: Mr. **Mikael Lilje** (Sweden)

Rapporteur: Mr. **Susheel Dangol** (Nepal)

This first plenary session has special focus on climate change in the Asia Region, where we will explore the transformative role of surveyors and land practitioners in tackling one of humanity's greatest challenges. The session delves into how we can safeguard vulnerable communities, promote climate-responsive land governance, and strengthen resilience against natural disasters. With the UN's 2030 Agenda as our guide, join us to discuss practical solutions and actionable insights that align with the Sustainable Development Goals (SDGs). Together, let's drive meaningful climate action and foster a sustainable future for the Asia region.

Pranab Ranjan Choudhury (India):
Making a Case for Climate Responsive Land Administration



Mr. **Pranab Ranjan** co-founded and leads Land-stack, a global south think tank, that seeks to enrich and expand the land governance ecosystem with more information, institutions and innovations. He spearheads India Land and Development Conference (ILDC), an annual convening of inter-sectoral, inter-disciplinary and inclusive land conversations.

As a Scientist with National Agricultural Research System earlier, and later as a development actor, Pranab, has been engaging with interdisciplinary issues connecting natural resources, climate and local communities, for more than three decades. He has worked with governments, civil society, academia and private sector, in action research, technology pilot and integrated projects focusing communities – women, tribal, small farm-

ers, mostly in South Asia. He has led and guided largescale projects, set up socio-ecological start-ups and has contributed to many collaborative platforms/networks. Academically, apart from engaging with teaching, research and training initiatives with global and national institutions, he also publishes regularly to enhance outreach and impact of his works. He sits as advisor and board member to several global and Indian institutions, working at the interface of land, development, and climate.

Markus Kukkonen (Laos, PDR):
Strengthening Land Rights Recognition in Forestlands



Mr. **Markus Kukkonen** works as a Senior Land Administration Specialist in World Bank's Urban, Resilience and Land Practice of the East Asia and Pacific Region. He is leading World Bank's land engagements in Laos and Nepal. Markus'

technical background is in GIS and remote sensing, while thematically he has focused on tenure security, land registration, forest tenure, and land use management. Besides Laos and Nepal, he has worked in the land administration sectors of Myanmar, Indonesia, Vietnam, Tanzania, Bosnia–Herzegovina, and Croatia. Markus holds a Master of Science (Geography) degree from University of Turku, Finland.

Ganesh Prasad Bhatta (Nepal):
Reviewing Climate Change – Land Nexus in National Policies in Nepal



Mr. **Ganesh Prasad Bhatta** is the Joint Secretary and Spokesperson for the Ministry of Land Management, Cooperatives, and Poverty Alleviation in the Government of Nepal. With over 25 years of dedicated experience in land administration, geospatial technology, and public sector leadership, Mr. Bhatta is a well-known figure in land



www.yakandyeti.com

management and geospatial sector in Nepal. He earned an M.Sc. degree in Land Administration from ITC, the Netherlands (2010), and is currently a part-time Ph.D. scholar at Kathmandu University, conducting research on Climate Responsive Land Governance.

Mr. Bhatta's career is marked by significant leadership roles, including serving as Executive Director of the Land Management Training Center (LMTC), Director General of the Survey Department, and Province Secretary at the Ministry of Physical Infrastructure Development in Sudur Paschim Province. He is dedicated to leveraging his expertise to make impactful contributions to land administration, management, and geospatial sectors of Nepal.

Paula Dijkstra (Netherlands):
Unlocking the Power of Geospatial Data for Sustainable Development by the Surveying Community



As the Director of Kadaster International, Ms. **Paula Dijkstra** oversees the coordination of the organization's global initiatives and international cooperation projects. Kadaster International offers consultancy services to governments worldwide in land administration, geo-information services, e-governance, and SDI implementation.

Joining the international department in 2011, Paula brings extensive experience to her role. Her academic background includes a Master's degree in Social Geography, com-

plemented by specialized training in GIS, cadastral data acquisition, and 3D modeling.

Currently, Paula serves as the chair of the FIG task force dedicated to advancing the Sustainable Development Goals. Additionally, she had the honor of being appointed as the co-conference director for the e-Working Week of the International Federation of Surveyors (FIG), hosted by the Netherlands. She successfully transitioned the event to a fully virtual format, delivering a highly effective conference experience in June 2021

Plenary Session II: Disaster Resilience

Time: Friday 15 November 2024 at 9:00–10:45

Place: Regal Ballroom, Hotel Yak and Yeti, Kathmandu

Chair: Ms. **Winnie Shiu** (Hong Kong SAR, China)

Rapporteur: Dr. **Subash Ghimire** (Nepal)

This essential session on disaster management tailored, explores how surveying expertise in land governance, geospatial data, and land rights is pivotal in building disaster resilience across the Asia region setting the scene for practical strategies for mitigating the impacts of natural disasters on vulnerable communities, ensuring security of tenure, and enhancing sustainable land management practices. Grounded in the UN's 2030 Agenda for Sustainable Development and the FIG's vision of climate action, the discussion will focus on how surveyors and land practitioners can use their skills to safeguard communities and landscapes against the growing threats of climate-induced disasters. Gain insights, share knowledge, and be inspired to take proactive roles in addressing the urgent challenges of disaster resilience.

Birendra Bajracharya (Nepal): *Earth Observation Applications for Enhanced Resilience to Climate-induced Disasters*



Mr. **Birendra Bajracharya** serves as the Chief of Party of SERVIR-Hindu Kush Himalaya, a joint initiative of NASA and USAID. Using

satellite data and geospatial technology, SERVIR co-develops innovative solutions through a network of partners to improve resilience and sustainable resource management at local, national, and regional scales. Birendra has been with ICIMOD since 1995 and has worked extensively on spatial data infrastructure, decision-support systems, and geospatial and remote-sensing applications in relation to disasters, natural resources, biodiversity, and conservation planning and management.

He holds an MSc in geoinformatics, an MBA, and a BE in civil engineering. He represents ICIMOD at the Group on Earth Observations (GEO) and was a member of the GEO Post-2025 working group.

Rishiraj Dutta (Thailand): *Capacitating Southeast Asia through the Use of Geospatial Technology and Earth Observation Data for Improved Decision-Making*



Mr. **Rishiraj Dutta** is a Disaster Risk Reduction Practitioner and Researcher working to strengthen

adaptive capacity to climate change and providing practical insights for integrating climate perspectives to community-based adaptation. He serves as a Capacity Development Lead at the Asian Disaster Preparedness Center (ADPC) in Thailand providing support to training and capacity building activities in the region. During his 12-year career, he has published extensively, particularly on drought, and served at the United Nations Economic and Social Commission for Asia and the Pacific (UNESCAP), the U.N. Satellite Center (UNOSAT/UNITAR) and in various positions within ADPC. He was also a core drafting committee member of the Asia-Pacific Plan of Action on Space Appli-

cations for Sustainable Development 2018–2030. Furthermore, during his tenure at UNESCAP, he has played a significant role in drought management initiatives in the Asia-Pacific region by implementing various projects and capacity building programmes through the ESCAP Drought Mechanism, an Intergovernmental platform under the Regional Space Applications Programme for Sustainable Development (RESAP). He has also co-authored a flagship UN publication titled “Ready for the Dry Years: Building resilience to drought in South-East Asia,” in 2019 which outlines actions for ASEAN member States to mitigate the impacts of drought. This joint publication between UNESCAP and ASEAN aligns with their joint strategic plan of action on disaster management and was officially launched during the thirty-fourth meeting of the ASEAN Committee on Disaster Management (ACDM) in Mandalay, Myanmar, in April 2019.

Currently, he is also the ADPC representation for the Capacity Development

Working Group (CD-WG): Sub-group 3 of the Group on Earth Observations (GEO) as well as the Task Team Lead for Asia-Oceania Community of Practice (CoP) for the Earth Observation Training, Education, and Capacity Development Network (EO-TEC DevNet).

Rishi holds a doctorate degree in Applied Geoinformation and Earth Observation, a master's degree in Geoinformatics from the Faculty of Geoinformation Science and Earth Observation (ITC), University of Twente, The Netherlands and a bachelor's degree in Agriculture from Assam Agricultural University, in Jorhat, India.

Jagannath Aryal (Australia):

Disaster Resilience from the Lens of Earth Observation in the Digital Era



Trained as a proud surveyor from Nepal and internationally recognised leader of the geospatial community, Associate Professor Dr

Jagannath Aryal is an academic faculty at the University of Melbourne, Australia within the Department of Infrastructure Engineering. Dr Jagannath Aryal received his PhD degree in Optimisation and Systems Modelling from New Zealand. Dr Aryal led the Remote Sensing and Photogrammetry Commission of Surveying and Spatial Sciences Institute (SSSI), Australia as a national chair. At the University of Melbourne, Dr Aryal leads a research group on Earth Observation and AI. His research focuses on optimal utilisation of Earth Observation, geo-information, and geo-statistics to de-

velop new methods in Geomatics for urban systems taking sustainability and resilience into account. He currently serves as an associate editor of the IEEE Transactions on Geoscience and Remote Sensing (TGRS) journal, an editor of the Journal of Spatial Science (Taylor & Francis), and Remote Sensing (MDPI).

He is the course coordinator of the Master of Digital Infrastructure Engineering and Graduate Certificate in Digital Engineering Degrees at the University of Melbourne.

For details please visit:

<https://findanexpert.unimelb.edu.au/profile/865150-jagannath-aryal>

Ikram Ul Haq (Pakistan):

Land Rights, Digital Governance, and Disaster Preparedness: A Case Study of PULSE Implementation in Punjab



Mr. **Ikram ul Haq** serves as the Director General of the Punjab Land Records Authority and the Project Director for the Punjab Urban Land Systems Enhancement (PULSE)

Project, a World Bank-funded initiative focused on the digitization of urban lands and cadastral mapping in Punjab. He brings over 15 years of experience in various government departments and administrative roles.

Mr. Haq has graduated in Data Analytics from the University of Chicago, USA. He believes in evidence based policy making and use of data in government decision making. He has worked towards easing of

land transaction processing and partitioning of joint shareholding in Punjab, Pakistan contributing significantly towards land titling and economic safeguard for the people.

Dinesh Manandhar (Japan):

Low-Cost GNSS Receiver Systems for Disaster Management, Dynamic Air-Quality Monitoring, and Gateless Toll Gate



Dr. **Dinesh Manandhar** is an Associate Professor at The University of Tokyo. He received Ph. D. from The University of Tokyo,

Japan in 2001. He completed his Master's Degree in Space Technology Applications and Research (STAR) program with remote sensing and GIS majors from Asian Institute of Technology, Thailand in 1998. His work on GNSS Signal Authentication is now implemented in QZSS to authenticate QZSS, GPS, and Galileo signals. He is also a co-developer of the Indoor Messaging System (IMES). His research area includes GNSS signal design, signal authentication, jamming, interference and spoofing, indoor navigation, software-defined radio, and Ultra Wide Band (UWB). He is also involved in GNSS technology promotion by conducting training, workshops, seminars, and lectures in Asia and Africa.

Aerial Data Acquisition Equipment



AMC6150
Oblique Aerial
Photography System



ASC1150
Swing type
Aerial Photography
System



ALC2000
LiDAR
Measurement System

3D Real Scene Data

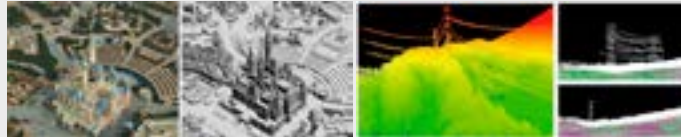

Contact Us

TerraIT Research GmbH Paul-Ehrlich-Str.1B, 63225 Langen Germany
+4917662199481 huangdong@smartearth.cn

**Habitat for Humanity
Nepal contributes
towards improving the
system and policies
that affect access to
sustainable, inclusive,
resilient, and adequate
housing.**



**Habitat
for Humanity®
Nepal**

**Celebrating 25 years of
building strength, stability and
self reliance through shelter**

Category A – Platinum Level

	Bentley Systems www.bentley.com
	Environmental Systems Research Institute, Inc. (ESRI), www.esri.com
	Leica Geosystems AG www.leica.com
	Trimble Navigation Ltd www.trimble.com

Category C – Silver Level

	Topcon Europe Positioning b.v. www.topconpositioning.com
--	---

Category D – Bronze Level

	GIM International – Geomares Publishing www.gim-international.com
	GIS/Transport Ltd. www.gistransport.com
	Mena 3D mena3d.com
	RIPRO Corporation, Japan www.ripro.co.jp
	Supermap Software Co, Ltd. www.supermap.com

Category E – Basic Level

	Al-Qotr Professional Consulting Company alqotr.sa
	Beijing iSpatial Co., Ltd, PRC ispacial.com.cn

	Geoide Geosystems S.a. www.geoide.pt
	Geoweb S.p.A www.geoweb.it
	Whitestar whitestar.com

Category F – Regional Level

	Alisteshaar Geospatial Consultancy alisteshaar.com
	Atlas Surveying atlas-surveying.com
	City Survey & engineering Consultants csecuk.com
	Construction Technological Services Private Limite, www.surveysrilanka.com
	GEO:connexion Ltd www.geoconnexion.com
	Georeference Engineering Consultants, Saudi Arabia, www.geotechsys.com/
	Geo-Tech Surveys Ltd, Ghana www.geotechsys.com/
	Multigeomatics Limited multigeomatics.com
	ORBITS Engineering Firm www.orbitseng.com
	Zimbabwe National Geospatial and Space Agency, zingsa.ac.zw

Category G – Other Sponsorship

	The Danish Society of Engineers, IDA https://english.ida.dk/
---	---

Welcome Dinner with Cultural Performances

Join the Welcome Dinner to get to know your fellow peers. There will be diverse cultural performances highlighting the ethnically rich culture of Nepal. The performances include dance forms like Mayur, Tappa, Deuda, Tamang Selo, Newari, Bhojpuri, and many more.

Event	Date	Time	Location	Details
Welcome Dinner	Thursday 14 November	18:00–21:00	Regal Ballroom, Hotel Yak and Yeti	All participants are invited

Accompanying Persons Programme

Accompanying persons are very welcome at the Regional Conference. Included in the registration for accompanying persons is the Inaugural Ceremony, Welcome Dinner and Closing Ceremony. Accompanying persons are welcome to register for and join the Technical/Social tour on Saturday 16 November 2024.

Technical & Social Tours

Participants will have the opportunity to explore the breathtaking beauty of the city by visiting tourist centers within the valley including the iconic places like Pashupatinath, Swayambhu, Bouddha, and Darbar square. (Not included in conference fee.) Participants can also enjoy mountain flights any day in the morning without disturbing their event schedule.

Discover Kathmandu Valley and its Surroundings

Saturday 16 November 4:30–17:00

Meeting point: The Lobby of Yak & Yeti hotel at 4:30 – the bus will leave the latest at 4:45, so please be on time. The bus will not wait in order to be on time for the sunrise.

Join us on an enriching social/technical tour through the Kathmandu Valley and its surroundings on November 16, 2024. Starting with an early morning departure from the conference hotel, we will head to Nagarkot for a breathtaking sunrise over the Himalayas, followed by a visit to the Nagarkot Geodetic Observatory. From there, our journey continues to Bhaktapur, a UNESCO World Heritage Site known for its ancient architecture and vibrant Newari culture. We will then visit the Land Management Training Center and Kathmandu University in Dhulikhel. Enjoy lunch amidst a serene environment before traveling back to Kathmandu to experience

the lively atmosphere of Handigaun’s car-free streets, filled with local food, crafts, and cultural activities.

Please note that while the travel time is estimated at around 3.5 hours but it may take longer due to traffic, so we recommend preparing for some flexibility in the schedule.



Sequential Route Map for the Social Tour.

Detailed Itinerary for the Social Tour

04:45	Depart from the conference hotel (Timely departure is essential, as any delay will result in missing the sunrise.)
06:00–07:00	Arrive at Nagarkot and enjoy the sunrise and sightseeing Nagarkot is a popular hill station located about 32 kilometers east of Kathmandu, renowned for its spectacular sunrise view over the mountains. When the weather is clear, it offers stunning panoramic views of the Himalayas including Mount Everest. Nagarkot is known for its peaceful surroundings, green landscapes, and hiking trails, making it a favourite escape for locals and tourists from the busy streets of Kathmandu. It also offers short treks and is close to ancient temples and traditional villages, adding to its cultural importance.
07:00–08:00	Visit the Nagarkot Geodetic Observatory
08:00–9:00	Light Breakfast (will be covered from the fee)
09:00	Travel back to Bhaktapur (14 km)
10:00–11:00	Visit Bhaktapur Durbar Square and its surroundings Bhaktapur is a must-visit destination for tourists looking to explore Nepal's historical and artistic treasures, along with experiencing the vibrant local culture and crafts. The city is also famous for its pottery, wood carving, and Nepali yogurt (juju dhau). Bhaktapur is a UNESCO World Heritage Site and is renowned for its stunning ancient architecture, temples, palaces, and courtyards, showcasing the artistic legacy of the Newar community. The major attractions of Bhaktapur Durbar Square are 55-Window Palace, Vatsala temple, Nyatapola Temple, and Dattatraya Temple.
11:00– 12:00	Travel to Dhulikhel (16.5 km)
12:00–13:30	Visit Land Management Training Center (LMTC) and Kathmandu University (KU) Lunch at the LMTC canteen (will be covered from the fee)
13:30–15:00	Travel back to Kathmandu (31 km)
15:00–17:00	Visit Handigaun, a vehicle-free area (on Saturday), and roam around the city, enjoying the indigenous culture
17:00	Return to the hotel / personal schedule



Sunrise view at Nagarkot
(Source: <https://outfitternepal.com/nagarkot-sunrise-and-hike>)



Nyatapola Temple.

Bhaktapur Durbar Square
(Source: Nepal Tourism Board)



Land Management Training Center and its premises.



Kathmandu University and its premises.
(Source: <https://www.facebook.com/kathmanduniversity>)



Glimpses of car-free Saturdays in Hadigaun, Kathmandu
(Source: <https://www.ratopati.com/>)

Car-free Saturdays in Hadigaun are a community-driven initiative designed to reclaim public spaces and celebrate local culture. Activities range from traditional games and slow-cycle races to cultural exhibitions and storytelling sessions that highlight the area's rich history. Visitors can enjoy a variety of local delicacies from food stalls set up along the vehicle-free streets. In addition to food, there are also handicrafts, pottery classes, and live performances, making it a full cultural immersion.



Ministry of Land Management, Cooperatives and Poverty Alleviation

The Ministry of Land Management, Cooperatives and Poverty Alleviation (MoLMCPA) is responsible for regulating land administration, land management, and the geospatial domain across the country. The ministry is dedicated to realizing the vision of “Equitable access to land, secured tenure, desired geo-information products, and quality services for all.” Its mission is to “Provide well-governed and high-quality services through a modern and streamlined system of national mapping, cadastral surveys, land administration, and land management.” In pursuit of this mission, the Ministry plays a central role in advancing land reforms, promoting equitable land ownership, and managing land resources systematically. Additionally, MoLMCPA oversees the regulation of cooperatives and coordinates poverty alleviation efforts throughout Nepal, contributing significantly to socio-economic development. To achieve its objectives, MoLMCPA operates through several key institutions: the Survey Department, the Department of Land Management and Archive, the Department of Cooperatives, the Land Management Training Center, and the Land Commission, along with various district-level units. The Ministry also has a strong international presence in the International Federation of Surveyors (FIG), with the Survey Department serving as a Member Affiliate and the Land Management Training Center as an Academic Member, representing Nepal in the global geospatial and surveying community.



Survey Department

Survey Department, the National Mapping Organization (NMO) of Nepal, established in 1957, serves as the national cadastral organization and the central nodal agency for National Spatial Data Infrastructure. It plays a critical role in land administration services through its 135 survey offices. It has started to implement advanced online services named Nepal Land Information System (NeLIS) and MeroKitta, enabling citizens to access various land-related services online. Department has completed the height measurement of the highest peak of the globe, the Mt. Everest, establishing its height 8848.86m, and also conducted high-resolution LiDAR surveys of western Terai part of Nepal, that aid in development and disaster mitigation planning. Additionally, NMO provides technical support for surveying and mapping of international boundary. Old series of topographical base map of Nepal was updated recently and published new version. Department has started in establishing Continuously Operating Reference Stations (CORS), and planned to establish country covered CORS network. The production of spatial data contributes in national development through use of those spatial data.



Land Management Training Center

Land Management Training Center (LMTTC), established in 1968 A.D., is the oldest and the only governmental institution continually and significantly producing human resources and enhancing the capacity of government personnel in the field of Surveying, Mapping, and Land Management since its establishment. LMTTC is certified with ISO 9001:2015 for Quality Management on 29 June 2022 A.D. The Center has been conducting a wide range of long and short-term training incorporating state-of-the-art modern technologies and has already produced more than 10,000 land professionals at different levels through various types of training courses. Along with this, LMTTC has collaborated to run academic courses with Kathmandu University (KU). Additionally, the Center contributes to the capacity building of Provincial and Local Governments in the field of land management and geospatial technologies.

PARTNERS

GLTN – gltn.net

KADASTER – www.kadaster.nl

The Ministry of Land Management, Cooperatives and Poverty Alleviation (MoLMCPA) – molcpa.gov.np

Survey Department – dos.gov.np

Land Management Training Center (LMTc) – lmtc.gov.np

THE WORLD BANK – www.worldbank.org

UN-HABITAT – unhabitat.org

SUPPORTERS

Community Self Reliance Center (CSRC) – Land Reform for Equitable Prosperity – csrcnepal.org

KATHMANDU UNIVERSITY – Department of Geomatics Engineering – geom.ku.edu.np

Nepal Remote Sensing and Photogrammetric Society (NRSPS), established in 1991 A.D., is a professional organization that works for promotion of Remote Sensing and Photogrammetry in the field of Surveying and Mapping in Nepal. NRSPS is one of the members of International Society for Photogrammetry and Remote Sensing,

(ISPRS) and Asia Pacific Regional Space Agency Forum (APRSFAF). www.nrsp.org.np

NAXA is a GeolCT service company specializing in the design and development of digital and spatial technologies that drive social good. Established in 2014 by a team of Geomatics Engineers from Nepal, NAXA has been at the forefront of digital mapping and geo-data management, delivering innovative solutions that support disaster management, urban planning, and sustainable development.

naxa.com.np

SPONSORS

TRIMBLE – Trimble is committed to enhancing connectivity between the physical and digital worlds through its advanced technology solutions in navigation, mapping, and spatial analytics. With over 40 years of innovation, Trimble aims to empower professionals across surveying, construction, agriculture, and transportation by addressing field and office challenges. As a sponsor of FIG Working Week, Trimble is invested in producing real-world solutions that enhance productivity and sustainability for professionals around the globe. www.trimble.com

TERRA-IT SmartEarth – TerraIT, as an international high-tech enterprise, has been at the forefront of the digital twin industry, leveraging over two decades of expertise in geospatial intelligence. The company's comprehensive experience has enabled it to establish a robust support system that covers the entire spectrum of data collection, processing, and application, which is crucial for the ad-

vancement of digital twin technology. TerraIT's solutions are underpinned by a suite of advanced reality capture sensors that TerraIT has developed in-house. The AMC, ASC, and UMC sensors are cutting-edge technologies that empower TerraIT to capture highly detailed and accurate geospatial data.

By integrating these self-developed sensors into their solutions, TerraIT is not only able to offer a higher level of customization and control over the data collection process but also ensures that the data is of the highest quality, which is vital for the accuracy and reliability of the digital twins they create. This end-to-end capability, from data acquisition to application, positions TerraIT as a leader in providing comprehensive digital twin solutions that are transforming how governments and industries manage and interact with their physical and digital assets.

www.smartearth.cn

HABITAT FOR HUMANITY – habitatnepal.org

ICIMOD – The Hindu Kush Himalaya (HKH) region stretches 3,500km across Asia, spanning eight countries – Afghanistan, Bangladesh, Bhutan, China, India, Myanmar, Nepal, and Pakistan. Encompassing high–altitude mountain ranges, mid–hills, and plains, the zone is vital for the food, water, and energy security of up to two billion people and is a habitat for countless irreplaceable species. It is also acutely fragile, and vulnerable to the impacts of the triple planetary crisis of climate change, pollution, and biodiversity loss.

The International Centre for Integrated Mountain Development (ICIMOD), based in Kathmandu, Nepal, is an international organisation established in 1983, that is working to make this critical region greener, more inclusive and climate resilient. For more information, read our Strategy 2030 and explore our website. www.icimod.org

KADASTER – The Netherlands’ Cadastre, Land Registry and Mapping Agency – in short Kadaster – collects and registers administrative and spatial data on property and the rights involved. Doing so, Kadaster protects legal certainty. We are also responsible for national mapping and maintenance of the national reference coordinate system. Furthermore, we are an advisory body for land–use issues and national spatial data infrastructures.

Kadaster has extensive knowledge and skills regarding land registration, land consolidation and geographic information. Based on these experiences, we work together with governmental institutions all over the world to further improve land administration. If rights are registered, owners have legal security.

A sound land registration is an instrument for economic development and improvement of living conditions. Land rights are part of the Sustainable Development Goals, to which Kadaster is fully committed. – www.kadaster.nl

SINO GNSS – **ComNav Technology Ltd.** is an OEM that develops and manufactures GNSS OEM boards, Receivers and Solutions. We serve 140+ countries with 800,000+ modules/receivers across industries like surveying, mapping, GIS, etc. Headquartered in Shanghai, we own 26,000m² industrial park, invest 20% of annual revenue in R&D, hold 70+ technology patents, and employ 600+ staff, ensuring rigorous quality control for top-tier positioning solutions – www.sinognss.com, www.facebook.com/comnavtech

PARTNERS



SUPPORTERS



PLATINUM SPONSOR



GOLD SPONSOR



BRONZE SPONSORS



MEDIA PARTNERS





oleksii.leonov - stock.adobe.com

IBRESTER - stock.adobe.com

Mani - stock.adobe.com

StockImageFactory - stock.adobe.com

Cultura Allies - stock.adobe.com

FIG Commissions and Task Forces involved in the Regional Conference

Commission 2	Professional Education – Dr. Dimo Todorovski , Netherlands
Commission 5	Positioning and Measurement – Dr. Ryan Keenan , Australia
Commission 7	Cadastre and Land Management – Dr. Rohan Bennett , Australia
Commission 8	Spatial Planning and Development – Dr. Kwabena Obeng Asiama , Ghana
Commission 9	Valuation and the Management of Real Estate – Mr. Peter Ache , Germany
Task Forces	Task Force on FIG and the SDGs – Ms. Paula Dijkstra , Netherlands
	Task Force on Climate Compass – Ms. Clarissa Augustinus , Ireland, and Ms. Roshni Sharma , Australia
	Task Force on Diversity and Inclusion – Mr. Stephen Djaba , Ghana



MICHEL – stock.adobe.com

Main Conference Overview (by rooms)

Thursday, 14 November			
	REGAL II	PLATINUM HALL	REGAL I (World Bank Sessions)
09:00–10:45	OPENING CEREMONY – Regal Ballroom		09:00–10:45
10:45–11:15	Tea Break – Restaurant, Regency Hall		10:45–11:15
11:15–12:45	PLENARY SESSION I: Climate Responsible Land Governance – Regal Ballroom		11:15–12:45
12:45–13:45	Lunch – Restaurant, Durbar Hall		12:45–13:45
13:45–15:15	TS01A: Innovative Approaches to Urbanization, Land Management and Climate Resilience – C: 8	TS01B: Unlocking Property Values through Greater Transparency of Sustainability Effects on the Markets – C: 9	TS01C: Towards a Modern and Localized Land Administration System : Launch of the Technical Assistance on the Digitalization of Nepal's Land Administration Sector– C: WB
15:15–15:45	Tea Break – Restaurant, Regency Hall		15:15–15:45
15:45–17:15	TS02A: Climate and disaster resilient rural land use planning – C:8	TS02B: Enhancing Disaster & Climate Resilience through Knowledge and Capacity – C: 2	TS02C: Property Valuation Systems and Standards: Addressing Challenges and Unlocking Opportunities– C: WB
Friday, 15 November			
08:00–08:45	TM01: Meeting on Call to Action – Senator Meeting Room		08:00–08:45
09:00–10:45	PLENARY SESSION II: Disaster Resilience – Regal Ballroom		09:00–10:45
10:45–11:15	Tea Break – Restaurant, Regency Hall		10:45–11:15
11:15–12:45	TS03A: Innovative Land Administration Approaches, Global Land and Environmental Frameworks – C: 7	TS03B: Leveraging Remote Sensing, GIS and Technological Innovations for Sustainable Development – C: 5	TS03C: Towards Effective Property Valuation and Taxation: Lessons, Analytics, and New Horizons – C: WB
12:45–13:45	Lunch – Restaurant, Durbar Hall		12:45–13:45
13:45–15:15	TS04A: Safeguarding Land Rights amidst the Impacts of Climate Change and Disasters – C:7	TS04B: Partner Spotlights	TS04C: Round Table Discussion on Property Valuation and Taxation – C: WB, 9
15:15–15:45	Tea Break – Restaurant, Regency Hall		15:15–15:45
15:45–17:15	CLOSING CEREMONY – Regal Ballroom		15:45–17:15
Saturday, 16 November			
04:30–17:00	TECHNICAL/SOCIAL TOUR		04:30–17:00



5th FIG Young Surveyors Network Asia and the Pacific Meeting

Join us for the **5th FIG Young Surveyors Network Asia and the Pacific Meeting** in **Kathmandu, Nepal**, an inspiring event held alongside the **FIG Regional Meeting**. Under the theme **“Empowered Youth for Climate Resilient Land”** this gathering is a call to action for young surveyors ready to address the pressing challenges of climate change, land rights, and disaster resilience.

As young professionals, your role is critical in shaping a sustainable future where land rights are recognized as fundamental to building disaster-resilient communities. This event will provide a pivotal platform for young surveyors from the region to enhance their expertise in land governance, enhancing their

capabilities to contribute effectively to resilience strategies amid climate threats.

Participate in sessions on open-source mapping for climate resilience, expert panels on geospatial technologies, and roundtable discussions on tenure security and land conflict resolution in post-disaster settings. Engage with experts, collaborate with peers, and explore innovative strategies to ensure sustainable and equitable land use in our changing world. Your voice matters – help us map a resilient future together by joining us in Dhulikhel, Nepal to advance your career and make a difference in the Asia-Pacific region.

Preliminary Programme

The event schedule includes keynotes, panel discussions, and interactive workshops focused on empowering young surveyors in climate-resilient land governance and disaster mitigation, along with the networking opportunities.

Time	Session
08:15–08:50	Registration and Coffee Break
08:50–10:40	Opening Ceremony
08:50–09:10	Welcome guests and participants. Representative from LMTC and FIGYSN
09:10–09:30	Welcome Address by Dr. Diane Dumanshie, President FIG
09:30–09:50	Welcome Address by Buddhi Narayan Shrestha, NICS
09:50–10:10	Keynote: <i>Building the Capacity of Young Surveyors as Leaders for Climate & Disaster Action</i> by Clarissa Augustinus, FIG.
10:10–10:30	Keynote: <i>Climate Change and Land Rights: Empowering Youth for Sustainable Land Governance</i> by Janak Raj Joshi, LMTC
10:30–10:40	Group Photo
10:40–11:00	Coffee Break
11:00–11:15	Young Surveyors Awarding Ceremony : John Brock’s Grant and FIG Foundation Grant
11:15–11:30	Presentation by John Brock, Australia
11:30–13:00	Panel Discussion: <i>Harnessing Geospatial Technologies for Youth Leadership in Land Governance and Climate Resilience</i> Dr. Ganesh Kumar Jimme, NSET, Sudeep Shrestha, LMTC, Uttam Pudasaini, NAXA, Tina Baidar, Survey Department
13:00–14:00	Lunch Break
14:00–15:00	Workshops (Parallel Session with Presentation and Discussion) <i>Open Source Mapping for Climate Change and Disaster Resilience</i> Session Chair (representative from, KU), Pragya Pant, OSM Community Nepal, Ashok Thakulla, OSM Community Nepal, Arun Bhandari, NGES, NAXA <i>Advocacy and Land Rights</i> Dr. Jagat Basnet, CSRC, Dharm Raj Joshi, ILC, Ram Kumar Sapkota, LMTC
15:00–15:15	Coffee Break
15:15–15:30	Warm Up Session
15:30–16:30	Roundtable: <i>Land Rights, Land Conflicts and Land Tenure Security in Post – Disaster Situation</i> Sharad Chandra Mainali, Survey Department, Prashant Ghimire, Survey Department
16:30–17:00	Closing Remarks

Thu, 9:00–10:45

INAUGURAL CEREMONY**THURSDAY, 14 NOVEMBER**
09:00–10:45**VENUE:** REGAL BALLROOM, HOTEL YAK AND YETI, KATHMANDU**CHAIR:** TIRTHA BHADUR PRADHANANG, PRESIDENT OF NICS

Welcome to Nepal. Join us in this festive inaugural ceremony with addresses and keynote presentations.

Inaugural address by **Hon' Balaram Adhikari**, Minister for Land Management, Cooperatives and Poverty Alleviation Government of Nepal.

Platinum sponsor of the event:



Diane Dumashie (United Kingdom): Land Governance for Climate Action: The Imperative for Land Professionals to Act (12943)

Bryn Fosburgh (USA): Next Phase Technological Solutions (12978)

Mika-Petteri Torhonen (Finland): Access to Land for Climate Goals in South Asia Region (12942)

Thu, 11:15–12:45

PLENARY SESSION I: CLIMATE RESPONSIBLE LAND GOVERNANCE**THURSDAY, 14 NOVEMBER**
11:15–12:45**VENUE:** REGAL BALLROOM, HOTEL YAK AND YETI, KATHMANDU**CHAIR:** MR. MIKAEL LILJE (SWEDEN)**RAPPORTEUR:** MR. SUSHEEL DANGOL (NEPAL)

This first plenary session has special focus on climate change in the Asia Region, where we will explore the transformative role of surveyors and land practitioners in tackling one of humanity's greatest challenges. The session delves into how we can safeguard vulnerable communities, promote climate-responsive land governance, and strengthen resilience against natural disasters. With the UN's 2030 Agenda as our guide, join us to discuss practical solutions and actionable insights that align with the Sustainable Development Goals (SDGs). Together, let's drive meaningful climate action and foster a sustainable future for the Asia region.

Pranab Ranjan Choudhury and **Richa Joshi** (India): Making a Case for Climate Responsive Land Administration (12952)

Malcolm Childress, Cynthia Berning (USA), **Markus Kukkonen** (Laos, PDR), **Heather Huntington** and **Jennifer Lisher** (USA): Strengthening Land Rights Recognition in Forestlands (12879)

Ganesh Prasad Bhatta, Reshma Shrestha, Dev Raj Paudyal and **Sunil Babu Shrestha** (Nepal): Reviewing Climate Change – Land Nexus in National Policies in Nepal (12913)

Paula Dijkstra (Netherlands): Unlocking the Power of Geospatial Data for Sustainable Development by the Surveying Community (12897)

Thursday, 14 November 2024 13:45–15:15

TS01A: INNOVATIVE APPROACHES TO URBANIZATION, LAND MANAGEMENT AND CLIMATE RESILIENCE**THURSDAY, 14 NOVEMBER 13:45–15:15****VENUE:** REGAL II, HOTEL YAK AND YETI, KATHMANDU**COMMISSION:** 8**CHAIR:** DR. RESHMA SHRESTHA (NEPAL)**RAPPORTEUR:** MR. PRASHANT GHIMIRE (NEPAL)

Dive into critical issues from mitigating urban sprawl's effects on food security and sustainability to harnessing Earth Observation data for resilient urban planning. Explore how participatory GIS and potential of earth observation data enhances climate responsiveness and community engagement for climate resilience. With insights into urban greenery, open spaces for disaster preparedness, waste management strategies using cutting-edge data applications, this session promises a compelling look at the future of climate-responsive land governance. Don't miss the chance to be part of the dialogue shaping Asia's resilient urban landscape.

Madhu Sudan Adhikari, Subash Ghimire (Nepal) and **Dev Raj Paudyal** (Australia): Urban Expansion and Its Consequences: Impacts on Food Security and Environmental Sustainability (12875)

Rekha Poudel, Rubi Chaulagain, Binita Adhikari and **Rojina Baral** (Nepal): Developing Criteria for Identifying Open Spaces for Disaster Preparedness in Rural Nepal (12906)

Umesh Bhurtyal and **Ananya Neupane** (Nepal): Analyse Participatory GIS in Enhancing FFPLA Systems, Focusing its Impact on Climate Responsiveness and Community Engagement (12907)

Ashish Rijal, Aayushma Timalisina, Rakshya Khatri, Ayusha Kumari Sah and **Soniya Mehta** (Nepal): Integrated Approach to Waste Management in Banepa Municipality: Combining Geographic Information System, Analytical Hierarchy Process and Network Analysis for Landfill Site Selection and Route Optimization (12908)

Nok Hang NG (Hong Kong SAR, China): Unlocking the Potential of Earth Observation Data in Cultivating a Climate-Resilient City (12934)

Aashish Gautam (Nepal): Exploring Urban Greenery: A Case Study of Roadside Trees in Pokhara Metropolitan City (12954)

TS01B: UNLOCKING PROPERTY VALUES THROUGH GREATER TRANSPARENCY OF SUSTAINABILITY EFFECTS ON THE MARKETS**THURSDAY, 14 NOVEMBER 13:45–15:15****VENUE:** PLATINUM HALL, HOTEL YAK AND YETI, KATHMANDU**COMMISSION:** 9**CHAIR:** MR. PETER R. ACHE (GERMANY)**RAPPORTEUR:** MR. HARISHARAN NEPAL (NEPAL)

Discover how market transparency can mitigate the effects of climate risks on property values. With insights from diverse case studies, we'll delve into innovative strategies to enhance property value amidst sustainability challenges. Join us to explore the intersection of land governance, climate resilience, and market dynamics, and help shape a more sustainable and transparent future in real estate.

Peter R. Ache (Germany): Misbehaving of Markets and the FIG-Goal of Transparency on Real Estate Markets (12902)

Hrvoje Tomić, Samanta Bačić, Miodrag Roić and **Goran Andlar** (Croatia): Exploring the Urban Green Infrastructure Index: A Case Study of Zagreb, Croatia (12904)

Victor Olonde (Kenya), **Raja Ram Chhatkuli** (Nepal), **John Gitau, Hellen Ndungu** and **Robert Lewis Lettington** (Kenya): Global Valuation Practice: Lessons for Nepal (12914)

Wolfgang Glunz (Germany): The Impact of Climate Risks on the Value of Real Estate Properties – How a Transparent Real Estate Market May Provide Solutions – As a Basis for Discussion (12916)

TS01C: TOWARDS A MODERN AND LOCALIZED LAND ADMINISTRATION SYSTEM: LAUNCH OF THE TECHNICAL ASSISTANCE ON THE DIGITALIZATION OF NEPAL'S LAND ADMINISTRATION SECTOR**THURSDAY, 14 NOVEMBER 13:45–15:15****VENUE:** REGAL I, HOTEL YAK AND YETI, KATHMANDU**CHAIR:** MR. DONGKYU KWAK (USA), SENIOR LAND ADMINISTRATION SPECIALIST, WORLD BANK
RAPPORTEUR: MS. JENY SHRESTHA (NEPAL), URBAN CONSULTANT, WORLD BANK

The session, co-organized by the Ministry of Land Management, Cooperatives, and Poverty Alleviation (MLMCPA) and the World Bank, launches the new Technical Assistance for the "Digitalization of Nepal's Land Administration Sector." While cadastral and land registry records are largely digitized, further modernization is needed for greater efficiency and access. Decentralizing land administration services to municipalities, as required by the Constitution, is also essential. Nepal's land valuation and taxation systems face challenges, such as lacking standards and weak administration, and modernizing these systems is vital for fostering a transparent real estate market and enhancing revenue generation.

Key Messages

- Mr. **Mika-Petteri Torhonen** (Finland), Global Lead on Land, World Bank
- Mr. **Arjun Prasad Pokharel** (Nepal), Secretary, Ministry of Land Management, Cooperatives and Poverty Alleviation (MLMCPA)

Presentations

- **Land Administration System in Nepal: Challenges, Initiatives and Plans**
Mr. **Ganesh Prasad Bhatta** (Nepal), Joint Secretary, Ministry of Land Management, Cooperatives and Poverty Alleviation (MLMCPA)
- **Technical Assistance on the Digitalization of Nepal's Land Administration Sector: Overview and Next Steps**
Mr. **Danilo Antonio** (South Korea), Land and Geospatial Specialist, World Bank
- **Comments/Reactions**
Mr. **Prakash Joshi** (Nepal), Director General, Department of Survey, MLMCPA

Q and A**Closing**

TS02A: CLIMATE AND DISASTER RESILIENT RURAL LAND USE PLANNING

THURSDAY, 14 NOVEMBER 15:45–17:15

VENUE: REGAL II, HOTEL YAK AND YETI, KATHMANDU

COMMISSION: 8

CHAIR: MR. JANAK RAJ JOSHI (NEPAL)

RAPPORTEUR: MR. TANKA PRASAD DAHAL (NEPAL)

Prepare to delve into the forefront of geospatial technology and innovative policies for land use planning. Discover how cutting-edge tools and strategies are transforming land use planning, enhancing food security, and building climate resilience. From UAV imagery to multi-hazard early warning systems, and from land use zoning to precision agriculture, this session will redefine your understanding of climate-responsive land governance.

Vivek Dumre, Monika Manandhar, Rajan Adhikari, Sunil Sah, Susmita Chaudhary, Ajay Thapa, Janak Raj Joshi and Reshma Shrestha (Nepal):

Assessment of Land Degradation in Khotang District using Remote Sensing and GIS (12864)

Gonpo Tenzin, Chenchu Tshering, Pema Wangda and Tika Chhetri

(Bhutan): National Land Use Zoning: A Harmonized Land Use System Towards Climate Responsive Land Governance (12882)

Tanka Prasad Dahal, Purna Bahadur Nepali and Reshma Shrestha (Nepal): Policies and Institutions for Land Use Planning in Nepal: Implementation Status Review for Food Security (12922)

Binod Prasad Bhatta, Gorakh Nath Pandey, Mamta Kadel, Sadiqshya Adhikari, Manoj Kumar Bhat (Nepal), Shangharsha Thapa (Sweden), **Sujan Sapkota and Shreejan Pokharel** (Nepal):

Precision Agriculture in Nepal: Multi-phase Evaluation of Wheat Genotypes Using Multispectral UAV Imageries (12923)

Ashok Shrestha (Nepal):

Application of Web Based Model on Land Pooling (12926)

Kiran Bhusal, Ashok Thakulla and Aarati Poudel (Nepal):

Multi-Hazard Early Warning System (MHEWS) in Janaki Rural Municipality: A GIS Perspective (12929)

TS02B: ENHANCING DISASTER & CLIMATE RESILIENCE THROUGH KNOWLEDGE AND CAPACITY

THURSDAY, 14 NOVEMBER 15:45–17:15

VENUE: PLATINUM HALL, HOTEL YAK AND YETI, KATHMANDU

COMMISSION: 2

CHAIR: DR. DIMO TODOROVSKI (NETHERLANDS)

RAPPORTEUR: MR. RAM KUMAR SAPKOTA (NEPAL)

Step into the future of resilience through collaborative, knowledge-driven approaches! Join us as we explore global perspective on geomatics education's role in advancing territorial governance. Uncover the transformative impact of surveyors, working alongside communities to build resilient infrastructures. Gain insights into cutting-edge GNSS monitoring for safeguarding transportation networks against natural disasters.

Angel Collado (Spain):

A Global Perspective on Geomatics Education for Territorial Governance (12884)

Masaru Kaidzu (Japan):

Effort to Keep Number of Field Surveyors (12886)

Achut Krishna Pandey, Subash Ghimire and Suresh Chaudhary (Nepal):

A Community-driven Approach to Landslide Hazard Mapping, Risk Assessment and Management In Nepal (12887)

John Brock (Australia):

How Surveyors Have Changed the World Part II! (12924)

Jun Wang, Ryan Keenan and Leo Hellen (Australia):

Enhancing Natural Disaster Resilience in Transportation Infrastructure Using Kurloo GNSS Monitoring (12950)

TS02C: PROPERTY VALUATION SYSTEMS AND STANDARDS: ADDRESSING CHALLENGES AND UNLOCKING OPPORTUNITIES

THURSDAY, 14 NOVEMBER 15:45–17:15

VENUE: REGAL I, HOTEL YAK AND YETI, KATHMANDU

COMMISSION: WORLD BANK

CHAIR: DR. MIKA-PETTERI TÖRHÖNEN (FINLAND)

RAPPORTEUR: MR. DANILO ANTONIO, REPUBLIC OF KOREA

South Asia's rapid urbanization and economic growth are driving significant real estate development. A robust land and property valuation system is vital for enabling informed decisions by governments, investors, and developers while facilitating various societal functions. However, weak land administration systems persist in the region, and property valuation and taxation systems, standards, and professions are weakly regulated and overseen. This session aims to explore these challenges and initiate efforts to strengthen learning exchanges, potentially leading to the establishment of a regional Community of Practice focused on land and property valuation.

Subash Ghimire (Nepal), **Danilo Ramos Antonio** (Philippines), **Markus Olavi Kukkonen** (Finland) and **Ganesh Prasad Bhatta** (Nepal):

Land and Property Valuation in Nepal (12889)

Upuli Perera (Sri Lanka):

Land and Property Valuation and Taxation in Sri Lanka (12973)

Prem Bdr. Chhetri (Bhutan):

Land and Property Valuation and Taxation in Bhutan (12974)



WELCOME DINNER

THURSDAY, 14 NOVEMBER

18:00–21:00

VENUE: REGAL BALLROOM, HOTEL YAK AND YETI, KATHMANDU

All attendees are invited to this Welcome Dinner. The dinner is supported by the World Bank and enables participants to meet and greet in a more relaxed setting and to celebrate the achievements of the first conference day.



Friday, 9:00–10:45

PLENARY SESSION II: DISASTER RESILIENCE

FRIDAY, 15 NOVEMBER 09:00–10:45

VENUE: REGAL BALLROOM, HOTEL YAK AND YETI, KATHMANDU

CHAIR: MS. WINNIE SHIU (HONG KONG SAR, CHINA)

RAPPOREUR: DR. SUBASH GHIMIRE (NEPAL)

This essential session on disaster management tailored, explores how surveying expertise in land governance, geospatial data, and land rights is pivotal in building disaster resilience across the Asia region setting the scene for practical strategies for mitigating the impacts of natural disasters on vulnerable communities, ensuring security of tenure, and enhancing sustainable land management practices. Grounded in the UN's 2030 Agenda for Sustainable Development and the FIG's vision of climate action, the discussion will focus on how surveyors and land practitioners can use their skills to safeguard communities and landscapes against the growing threats of climate-induced disasters. Gain insights, share knowledge, and be inspired to take proactive roles in addressing the urgent challenges of disaster resilience.

Birendra Bajracharya (Nepal):

Earth Observation Applications for Enhanced Resilience to Climate-Induced Disasters (12944)

Rishiraj Dutta (Thailand):

Capacitating Southeast Asia through the Use of Geospatial Technology and Earth Observation Data for Improved Decision-Making (12925)

Jagannath Aryal (Australia):

Disaster Resilience from the Lens of Earth Observation in the Digital Era (12938)

Ikram Ul Haq and Nabeel Javed (Pakistan):

Land Rights, Digital Governance, and Disaster Preparedness: A Case Study of PULSE Implementation in Punjab (12941)

Manandhar Dinesh (Japan):

Low-Cost GNSS Receiver Systems for Disaster Management, Dynamic Air-Quality Monitoring, and Gateless Toll Gate (12959)

Friday, 8:00–8:45

TM01 – MEETING ON CALL TO ACTION

FRIDAY, 15 NOVEMBER 08:00–08:45

VENUE: SENATOR MEETING ROOM (ORGANISER ROOM)

CHAIR: DR. CLARISSA AUGUSTINUS, IRELAND

Interested attendees are invited to this meeting to discuss the draft Call to Action. The Call to Action will be finalised for the Closing Ceremony. Please see the draft Call to Action (link as a QR code)



Friday, 15 November 11:15–12:45

TS03A: INNOVATIVE LAND ADMINISTRATION APPROACHES, GLOBAL LAND AND ENVIRONMENTAL FRAMEWORKS

FRIDAY, 15 NOVEMBER 11:15–12:45

VENUE: REGAL II, HOTEL YAK AND YETI, KATHMANDU

COMMISSION: 7

CHAIR: MR. LUC GROOT (NETHERLANDS)

RAPPOREUR: MR. SUDEEP SHRESTHA (NEPAL)

Explore innovative land administration strategies that are building resilient communities and advancing sustainable development to tackle today's global challenges. Discover the use of AI for automatic digitization of historical cadastral maps, shifts in land cover, modern techniques for land parcel demarcation in flood-prone areas, and the power of geospatial data for effective crisis response. Gain insights into Asia-Pacific's approach and capacity for climate-responsive land administration, and see how these advancements are paving the way toward a more sustainable future.

Nabin Kumar Sah, Bishal Khatri and Subash Ghimire (Nepal):

Modern Approaches of Land Parcel Frequent Demarcation of Highly Flooded Prone Zone of Koshi River Basin (12880)

Sanjeevan Shrestha, Tina Baidar and Shangharsha Thapa (Nepal):

Improving Cadastral Accuracy for Disaster Management: The Role of Segment Anything Model (SAM) in Digitizing Historical Cadastral Maps (12895)

Muhammad Sheraz Ahsan, Salman Atif (Pakistan), **Christiaan Lemmen** (Netherlands), **Ejaz Hussain** (Pakistan) and **Mila Koeva** (Netherlands):

Assessing Urban Land Administration Capacity to Achieve 2030 Agenda for Sustainable Development in Pakistan (12905)

Eva-Maria Unger, Claudia Lindner (Netherlands), **John Gitau** (Kenya), **Raja Ram Chhattkuli and Janak Raj Joshi** (Nepal): Effective Land Administration in the Asia-Pacific Region: Insights from Nepal on Navigating Governance, Legal, and Financial Pathways within the Climate Change – Land Nexus (12918)**Narayan Thapa and Sushant Sharma** (Nepal): Integrating Machine Learning and Community-Based Approaches for Enhanced Early Warning Systems in Cascading Hazard Zones: A Case Study from Melamchi, Nepal (12951)**Pragya Pant, Narayan Thapa, Sujan Nepali and Suman Sanjel** (Nepal):

Land Cover Change Before and After the Sendai Framework of Disaster Risk Reduction (12953)

TS03B: LEVERAGING REMOTE SENSING, GIS AND TECHNOLOGICAL INNOVATIONS FOR SUSTAINABLE DEVELOPMENT

FRIDAY, 15 NOVEMBER 11:15–12:45

VENUE: PLATINUM HALL, HOTEL YAK AND YETI, KATHMANDU

COMMISSION: 5

CHAIR: DR. RYAN KEENAN (AUSTRALIA)

RAPPOREUR: MS. TINA BAIDAR (NEPAL)

Embark on a journey through the latest innovations in remote sensing, GIS, and technology, transforming the path to sustainable development! From monitoring coral reef health and supraglacial lake trends to deploying low-cost GNSS systems for disaster management, this session dives into transformative applications. Learn about innovative UAV, LiDAR, and geophysical techniques for landslide monitoring and how GNSS supports climate-responsive land governance.

Pradeep Upadhyay, Prawal Parajuli, Arun Bhomi, Rabina Poudyal and Yubraj Kawar (Nepal):

Assessing Coral Reef Changes through Supervised Classification and its Correlation with SST and Chlorophyll-A: A Remote Sensing Approach (12876)

Sandesh Upadhyaya, Prabin Gyawali, Shanker KC, Suresh Shrestha and Stallin Bhandari (Nepal):

The Fundamental Role of GNSS in Modern Surveying and Mapping to Support Climate Responsive Land Governance and to Enhance Disaster Resilience (12890)

Sanchitha Lakshan Witharana and Eranda Gunathilaka (Sri Lanka):

Utilizing UAV, LiDAR, and Subsurface Geophysical Mapping Techniques for Comprehensive Landslide Monitoring in Sri Lanka (12899)

Chokila Chokila, Phurba Phurba, Kinzang Thinley, Jamphei Gyeltshen (Bhutan) and **Rui Fernandes** (Portugal): Enhancing Land Governance and Disaster Resilience in Bhutan through DrukNet (12917)**Sudipta Poudel, Aman Manandhar, Pratima Thapa and Asmita Banepali** (Nepal):

Yield Estimation of Rice Using Multispectral Imagery from UAV in Nepal (12919)

Kabiraj Rokaya and Shristi Paudel (Nepal):

Assessment of Trend of Supraglacial Lake Development in Western Nepal (12931)

TS03C: TOWARDS EFFECTIVE PROPERTY VALUATION AND TAXATION: LESSONS, ANALYTICS, AND NEW HORIZONS

FRIDAY, 15 NOVEMBER

11:15–12:45

VENUE: REGAL I, HOTEL YAK AND YETI, KATHMANDU

COMMISSION: WORLD BANK

CHAIR: MS. PAULA DIJKSTRA (NETHERLANDS)

RAPPOREUR: MS. HELLEN NYAMWERU (KENYA)

Property valuation plays a crucial role in economic development, wealth creation, and sustainability. A robust valuation infrastructure underpins property trading, mortgaging, taxation, compensation, planning and financial reporting. Reliable valuation also facilitates the efficient transfer of land rights, supports financing for sub-national governments, and enhances spatial planning. It strengthens banking and financial markets stability by better accounting, lending and insurance. This session aims to highlight experiences and analytics on how effective land and property valuation can increase revenue generation and improve urban infrastructure and municipal services.

Danilo Antonio (Republic of Korea):

Land and Property Valuation for Sustainable Urbanization: Findings and Recommendations from East Asia (12975)

Mahesh Thapa (Nepal): GIS-based Property Valuation: Lessons Learned from Banepa Municipality (12976)**Dongkyu Kwak** (USA): The Role of New Technologies in Own-Source Revenue Generation (12977)

TS04A: SAFEGUARDING LAND RIGHTS AMIDST THE IMPACTS OF CLIMATE CHANGE AND DISASTERS**FRIDAY, 15 NOVEMBER 13:45–15:15****VENUE:** REGAL II, HOTEL YAK AND YETI, KATHMANDU**COMMISSION:** 7**CHAIR:** MS. PAULA DIJKSTRA (NETHERLANDS)**RAPPORTEUR:** MR. SANJEEVAN SHRESTHA (NEPAL)

Step into the crucial conversation on safeguarding land rights in the face of climate and disaster challenges. From addressing the unique impacts of land tenure reforms on women in Papua New Guinea to advancing collaborative governance in Indonesia, this session has it all. Discover cutting-edge tech solutions, like GNSS data processing for climate and disaster induced challenges and a Python library for detecting inconsistency in land records, for addressing land safeguarding challenges. Learn from Nepal's journey to balance land access for the landless while protecting public lands and formalizing rights for marginalized communities, driving sustainable land management and social justice forward.

Flora Kwapena (Papua New Guinea): Impact of Customary Land Tenure Systems and Reforms on Women In Papua New Guinea (12874)

Dony Erwan Brilianto, Vito Haga Mursa and Ayu Nadiyahani (Indonesia): Collaborative Governance for Safeguarding Land Rights in Indonesia (12881)

Yuri Noyanov (Russia): GNSS Data Processing Package to Address Climate Change and Disaster Induced Challenges in Safeguarding Land Rights (12891)

Mahesh Thapa (Nepal): A Python Library for Detection of Inconsistencies between Parcel Database and Plot Register (12900)

Raja Ram Chhatkuli, Pragna Pradhan, Jagat Deuja (Nepal), **Hellen Ndungu and Victor Olonde** (Kenya): Balancing Access to Land for the Landless and Protection of Government and Public Land: The case of Sustainable Land Management in Nepal (12901)

Dharm Raj Joshi and Tripti Mahaseth (Nepal): Formalization of Land Rights of Landless and Informal Settlers in Nepal: A Journey towards Establishing Social Justice (12911)

TS04B: PARTNER SPOTLIGHTS**FRIDAY, 15 NOVEMBER 13:45–15:15****VENUE:** PLATINUM HALL, HOTEL YAK AND YETI, KATHMANDU**CHAIR:** MR. MIKAEL LILJE (SWEDEN)**RAPPORTEUR:** MR. SHARAD CHANDRA MAINALI (NEPAL)

This session offers a unique chance to learn from our sponsors and partners how their tools enhance resilience, safeguard land rights, and drive sustainable development goals. Don't miss out on the insights, networking, and opportunities to collaborate with experts and leaders shaping the future of climate-responsive land governance! Thanks to our sponsors for being part of this conference.

Subhash Kumar (India): CORS for Atmospheric Studies and Disaster Mitigation. (12957)

Luc Groot (Netherlands): Digital Transformation in Land Administration: Kadaster's Experiences in the Netherlands and Abroad (12961)

Dong Huang (China, PR): SmartEarth 3D Real Scene Product and Service Solution (12971)

Prudence Xu (China, PR): Mars Laser RTK – Changer in the World of Surveying and Mapping (12972)

TS04C ROUND TABLE DISCUSSION ON PROPERTY VALUATION AND TAXATION**FRIDAY, 15 NOVEMBER 13:45–15:15****VENUE:** REGAL I, HOTEL YAK AND YETI, KATHMANDU**COMMISSION:** WORLD BANK AND 9**CHAIR:** MR. PETER R. ACHE (GERMANY)**RAPPORTEUR:** DR. CLARISSA AUGUSTINUS (IRELAND)

All authors and presenters from TS01B, TS02C and TS03C are encouraged to participate in this roundtable discussion together with interested participants.

CLOSING CEREMONY**FRIDAY, 15 NOVEMBER 15:45–17:15****VENUE:** REGAL BALLROOM, HOTEL YAK AND YETI, KATHMANDU**CHAIR:** MR. NIRAJ MANANDHAR, VICE PRESIDENT OF NICS

*The Closing Ceremony will first and foremost wrap up the findings and outcome from the sessions throughout the two conference days. Each session will contribute to this summary. A Call to Action, presented by Dr. **Clarissa Augustinus**, will be handed over by Dr. **Diane Dumashie**, FIG President, to the Special Guest, Mr. **Arjun Prasad Pokharel**, Secretary of the Ministry of Land Management. The Call to Action and the outcome of the conference will be published in an action-oriented FIG Publication.*





LAND REFORM FOR EQUITABLE PROSPERITY

CSRC
आत्मनिर्भर केन्द्र

Community Self Reliance Centre

NATIONAL CIVIL SOCIETY ORGANIZATION FACILITATING
LAND AND AGRARIAN RIGHTS CAMPAIGNS FOR MORE
THAN 3 DECADES

MARS

LASER RTK

SinoGNSS



Laser
Technology

K8
Module

Full-Constellation
Multi-Frequency

Quick Charge

PPP IP67



THE FIG FOUNDATION

The FIG Foundation is an independent body under the International Federation of Surveyors and has been established for the purpose of raising funds to finance surveying education development projects and supporting young surveyors in order to build a sustainable future. The FIG Foundation will build a sustainable future by::

- grants and scholarships to projects, for instance to develop curricula for surveying education, training and capacity building, especially in developing countries;
- encouraging research into all disciplines of surveying and to disseminate the results of that research;
- promoting high standards of education and training for surveyors and to facilitate continuing professional development;
- educating people in the disciplines of surveying, particularly in developing countries and countries in transition;
- promoting the use of distance learning, networking, eLearning and knowledge management if surveying education and continuing professional development;
- promoting the exchange of surveying personnel for greater understanding of all facets of the profession of surveying;
- supporting by seed funding conferences, meetings of young surveyors and similar events in co-operation with international agencies such as the United Nations. .

Donations to the FIG Foundation

FIG Foundation is dependent on and appreciates all kinds of donations If you would like to give a donation to FIG Foundation, please find a FIG representative or donate directly at fig.net/figfoundation.













Iwona - stock.adobe.com

An exhibition is running concurrently with the conference showcasing the latest and best in surveying and spatial products and services. The exhibition takes place at Regency Hall on the 1st floor of Hotel Yak & Yeti.

Opening Hours

The exhibition is open on Thursday 14 November at 10:45 to 17:30, and Friday 15 November at 10:45 to 15:45.



	DOS (Survey Department of Nepal)	A1
	ICIMOD	A2
	Synspective/Satpalda/ Rajdevi	A3
	Geo 3D Modeling	A4
	FIG	A5
	TerraIT	B1
	ComNAV	B2
	Geospatial Systems Pvt Ltd	B3
	NAXA	B4
	Habitat for Humanity	B5

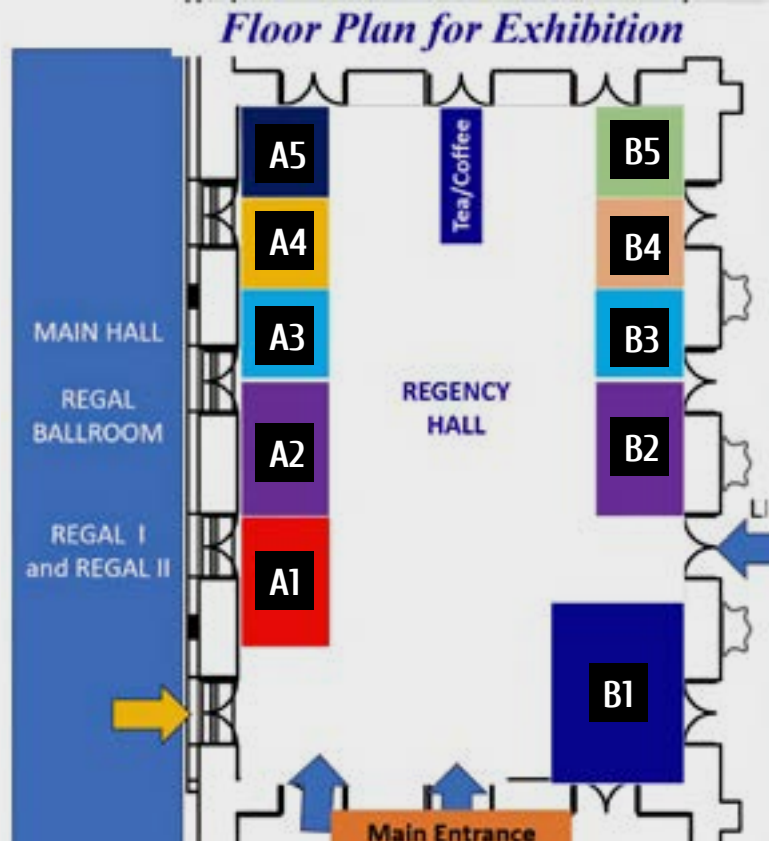



Innovation to support the way you work.

Elevate your surveying capabilities with technology tailored for everyday project demands. From advanced GNSS receivers, data collectors and innovative 3D laser scanning to comprehensive field and office software solutions, Trimble is your partner in unparalleled accuracy and efficiency.

Embrace the power of automated data collection, in-field processing and real-time visualization to conquer complex challenges and excel in land surveying, construction and environmental management. With Trimble, you're not just measuring land, you're shaping the future.



Find out more at:
geospatial.trimble.com



WORKING WEEK 2025

AND

Locate25 | **G**
THE NATIONAL GEOSPATIAL CONFERENCE



Geospatial
Council of Australia

**Collaboration, Innovation and Resilience:
Championing a Digital Generation**

Brisbane, Australia 6-10 April



FIG XXVIII Congress 2026

Cape Town, South Africa



International
Federation of
Surveyors (FIG)



South African
Geomatics
Council
(SAGC)



The South
African
Geomatics
Institute (SAGI)

The Future We Want – The SDGs and Beyond. Where we are, Where we want to be.

24–29 May 2026



FIG Working Week 2027

Stavanger Norway 23-27 May

The Power of Where for the new Generations



FIG Working Week 2028

Paris, France

Celebrating the 150th Anniversary of FIG

